

APPENDIX 1

DRAWING

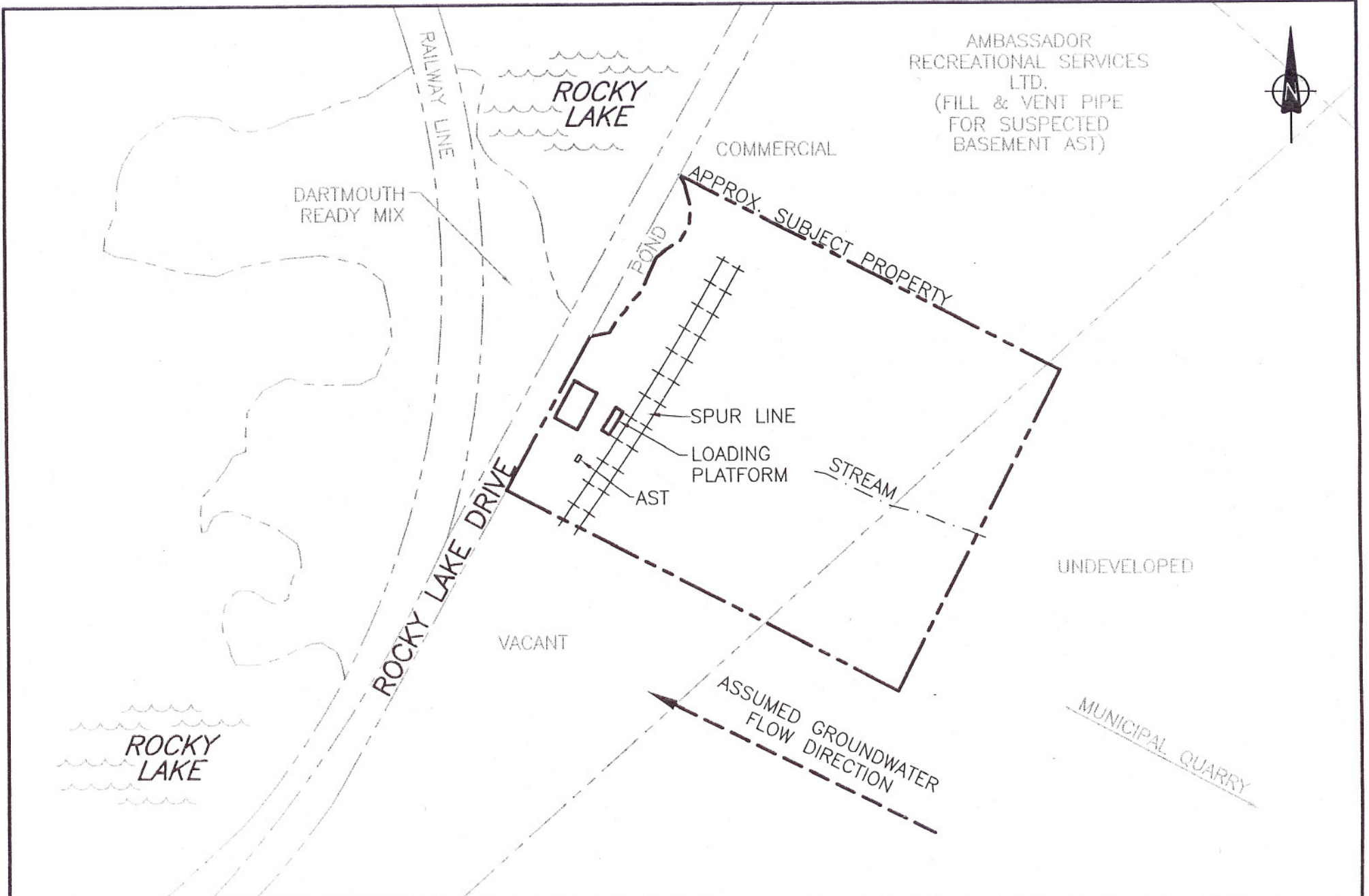



ALPHA CHEMICAL LTD.
PHASE I ENVIRONMENTAL SITE ASSESSMENT
 533 ROCKY LAKE DRIVE, BEDFORD, NS
SITE PLAN AND ADJOINING PROPERTIES

Scale : N.T.S.	Dwn. By: P.J.S00	App'd:
Date: 2004/06/08	Drawing No.: NSD18876-1	



APPENDIX 2
PHOTOGRAPHS





Photo 1 – 533 Rocky Lake Drive – View along Front of Building



Photo 2 – View along Back of Building



Photo 3 – Side View of Warehouse

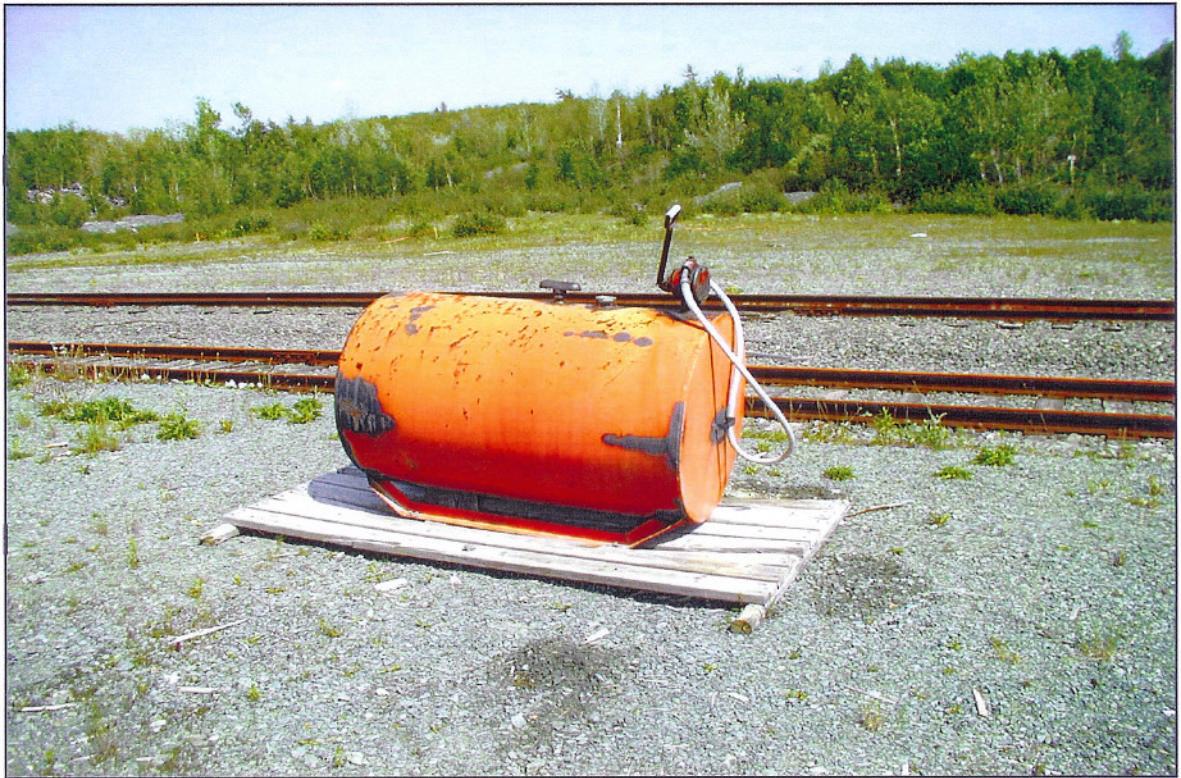

Photo 4 – Empty Fuel Oil AST Outside of Building



Photo 5 – Pond at Northwest Corner of the Site



Photo 6 – Rail Lines along Site



Photo 7 – Stream Running along Site



Photo 8 – View Towards Back of the Site



Photo 9 – Piles of Gravel near Back of Site



Photo 10 – Inside View of Warehouse



Photo 11 – Floor Drain in Warehouse