

AR 89-261

CARRICK GOLD RESOURCES LIMITED
Report on Geological Mapping and
Prospecting Cow Bay Licence 14744
and 14745 N.T.S. 11D / 11C N.S.
For Year Ending 23 November 1989.
J. O'Sullivan, & E. Macdonald

AR 89-261

CARRICK GOLD RESOURCES LIMITED

Report on

Geological mapping and Prospecting on
Cow Bay Claims, Licences 14744 and 14745.
N.T.S. 11D /11C Nova Scotia
For Year Ending 23 November 1989.

RECEIVED
DEC 7 15 57 '89
MINES
AND ENERGY

John O'Sullivan P. Eng.
Edwin Macdonald
Dartmouth, Nova Scotia
1989

DUPLICATE AVAILABLE

T A B L E O F C O N T E N T S

	<u>Page</u>
CONCLUSIONS AND RECOMMENDATIONS	1
INTRODUCTION	1
LOCATION AND LAND HOLDINGS	1
HISTORY AND PREVIOUS WORK	4
WORK COMPLETED	4
GEOLOGY	4
PROSPECTING	5

APPENDIX 1 LIST OF ASSAYS

FIGURES:	Title	Scale	
Figure 1	Claim Location Map	1:100,000	2
Figure 2	Claims	1" to 1/2 Mile	3

DRAWINGS:

01 ✓ Geology and Rock Geochemistry 1:5,000

WZ

CONCLUSIONS AND RECOMMENDATIONS

Prospecting and limited geological interpretation have shown the Cow Bay claims to have potential for economic gold concentrations in cross cutting quartz veins. The claims however, cover only a small part of the potential target making the systematic coverage of the area difficult. Follow up of magnetic anomalies by prospecting V.L.F. E.M. and trenching is planned.

INTRODUCTION

This report covers the work completed during the period from 23 November 1988 to November 1989 on six claims in the Cow Bay gold district.

The claims were staked to cover part of the old workings on the Lawrencetown gold District which produced a reported 803 oz. gold from 899 tons crushed.

A basic prospecting and gridding program has been carried out in addition to limited geological mapping.

LOCATION AND LAND HOLDINGS

The property consists of six claims, five of which are contiguous. They are located at Cow Bay, 10 kilometres southeast of Dartmouth. Access to the property is by paved road to within 200 metres of the property boundary. Access within the licence is restricted to a few bush trails .

All claims are in N.T.S. 11D/ 11C.

<u>LICENCE</u>	No. Claims	<u>TRACT</u>	<u>CLAIMS</u>	DATE of ISSUE
14744	5	10	GKLPQ	23 Nov. 1988
14745	1	11	J	23 Nov. 1988

HISTORY AND PREVIOUS WORK

Gold was discovered in the Cow Bay area in 1895 in a quartz vein cutting across stratigraphy on the contact between Goldenville Fm. greywackes and Halifax Fm. slates. Subsequently , numerous other cross cutting veins were located and in the period prior to 1905 shafts were sunk on several of these veins. A total of 803 oz. gold was produced

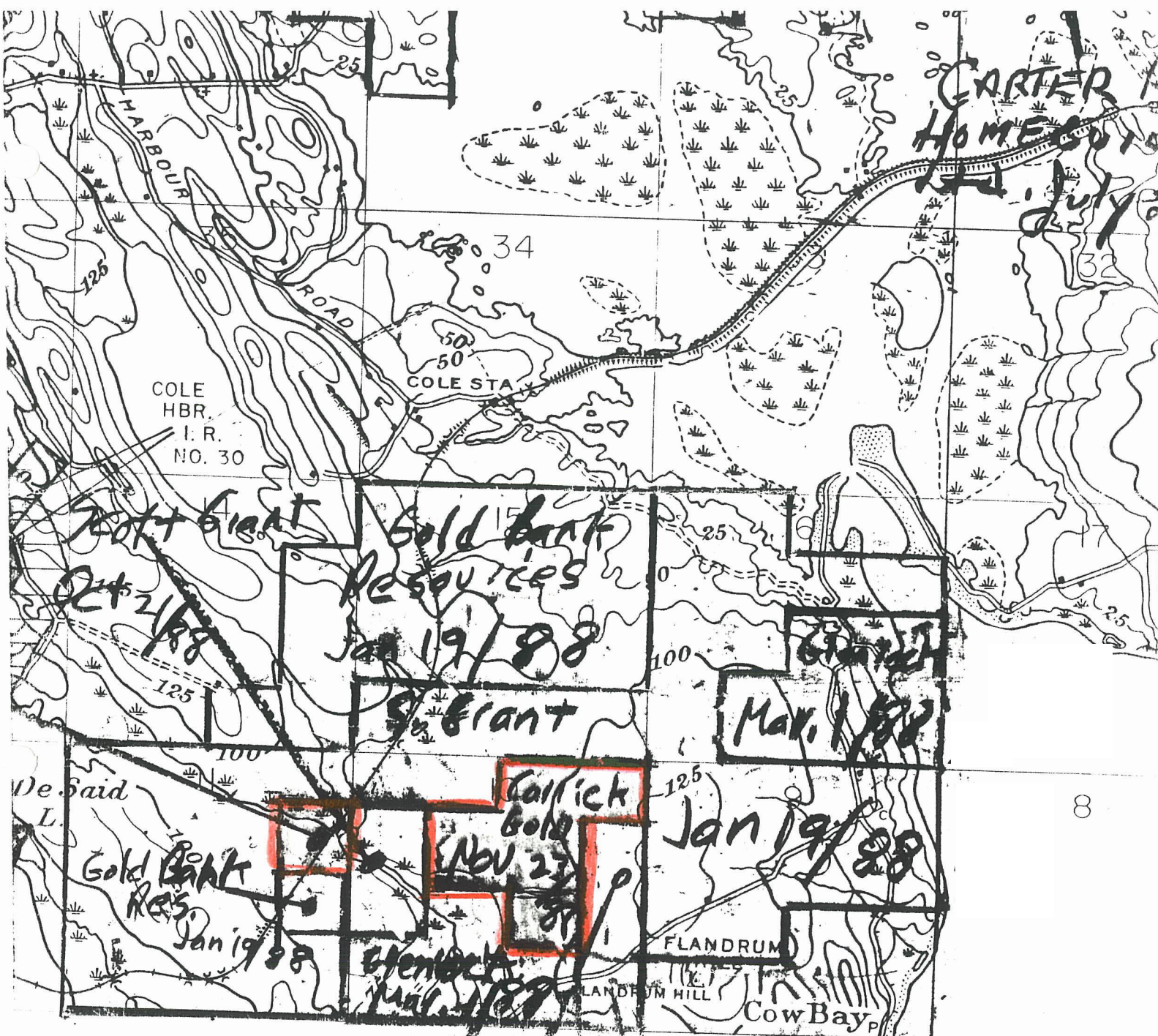

CARRICK Gold Resources Limited
 Cow Bay
 CLAIM LOCATIONS
 LICENCES 14744 14745
 Dec 1989 scale 1" to 1/2 mile

from 899 tons milled giving a grade of slightly less than one oz. / ton.

Records for more recent exploration are sparse, the most recently available reports describing an attempt to define by magnetics a pyrrhotite bearing horizon. The intersection of the cross cutting quartz veins and this pyrrhotite rich greywacke horizon produced gold enrichment. Within the past couple of years a number of companies have been carrying out exploration on the area surrounding Carricks ground, but results are not known.

WORK COMPLETED

Licence 14744

- (1) Flagged and chained grid 1.8 km.
- (2) Geological mapping and prospecting.

Licence 14745

- (1) Prospecting.

GEOLOGY and PROSPECTING

The property covers a southerly dipping contact between greywackes of the Goldenville Formation and slates of the Halifax Formation. Within the upper beds of the greywackes is a pyrrhotite enriched horizon, which when cut by quartz veins normal to the regional strike, shows gold enrichment. The general gold setting is significantly different to the majority of Meguma hosted gold deposits in that the gold is associated with cross cutting veins rather than bedded veins. An additional feature is that these zones occur well away from the anticlinal features which characterize the typical Meguma Deposits. The Cow Bay vein style is not unique amongst Nova Scotia producers, with Lepsigate and Blockhouse Gold Districts producing from cross cutting veins.

Numerous cross cutting quartz veins are shown on the regional geology map extending over a strike distance in excess of two kilometres. Carrick's property covers about 800 metres of the strike length. In the southwest of the licence is the Long Vein Shaft. Production from this mine is not known. Several overgrown trenches were located nearby.

In the northeastern half of the property is a large outcrop area of greywacke showing a northeast strike. The area is undulating in topography with greywacke ridges running 60 degrees azimuth. The greywacke is interbedded

with slate which is also showing a northeastern strike with the dip of the beds being vertical. The greywacke has thin crosscutting quartz veins that range from a few millimetres up to eight centimetres, but the majority of these are thin and bullish. In the troughs between the greywacke ridges is a thick mossy leached overburden.

The southeast portion of the contiguous claims has only sparse outcrop and extensive swamp.

A one kilometre base line was established as control for soil sampling and mapping. Seven hundred metres of crosslines were flagged in to explore the possibility of performing a soil sampling program. Due to large areas of greywacke outcrop, lack of soil and extensive swamp, soils were not taken.

PROSPECTING

Initial prospecting on the property revealed a shaft and a few overgrown trenches in the southwestern portion of license 14744. Slate and greywacke rubble is abundant in this area and quartz can be found in the rubble as thin crosscutting veins. The area of the trenches is easily accessed by an old wood road that is in good condition.

The northeastern portion of the property is an area of greywacke outcrop with some thin slate beds. Various thin crosscutting bull quartz veins are present in the greywacke. One eight centimetre quartz vein running 142 degrees, dipping 81 degrees east at 50+10 E, was sampled and had 31 PPB gold and 1250 PPB arsenic values. From the nature of the undulating topography it is suspected that the areas between greywacke ridges are slate beds that have been eroded. A trenching program is recommended to further test this hypothesis. A few soil pits were dug to test the type and abundance of overburden present. There is very little overburden present and only grey leached soil was found when any was found at all.

The area to the southwest of the outcrop is extensive swamp and wet woodlands, very sparse outcrop and dense bush make travelling difficult.

Access to License 14745 is good by a 2.3 kilometer walk down an old railroad track off of Caldwell Rd., no outcrop was encountered on this claim.

Due to the inability to carry out a meaningful soil geochemical program on the property and the amount of swamp coverage, a V.L.F. EM 16 program is recommended for the property once it is frozen. Also reopening of the old trenches and chip sampling is recommended and possibly dewatering of the Long Vein Shaft.

Bondar-Clegg & Company Ltd.
5420 Canotek Road
Ottawa, Ontario
K1J 8X5
(613) 749-2220 Telex 053-3233



Geochemical Lab Report

REPORT: 089-90170.0

PROJECT: MEADOW BROOK

PAGE 1

SAMPLE NUMBER	ELEMENT UNITS	As PPM	Au PPB
---------------	---------------	--------	--------

6951
~~8978~~
8778

2
~~1250~~
9

<5
~~31~~
<5

cow Bay

Revised



Department of
Mines and Energy

Report of Work Performed

I, the undersigned, holder of/agent for, Exploration License No. 14-744 issued on the 23 day of
NOVEMBER 19 88, hereby report work as follows:

I have, under said License, and in conformity with the provisions of The Mineral Resources Act, performed or caused to be performed on the licensed area 72.5 days' work (eight-hour days) not reported before, totalling \$ 1450.50 as per the attached list of expenditures. (Rate is one day's work for each \$20.00 spent.)

Expenditures relating to office overhead, transportation, lodging, freight, express, construction of roads, erection of buildings, etc., will be accepted up to a maximum of ten percent (10%) of the **required** work.

The said work consisted of GRIDDING, PROSPECTING, GEOLOGICAL MAPPING

Attached is a geological report with applicable maps, sample results, drill logs, etc., which is submitted as evidence and initialled by me.

My Post Office address is CARRICK GOLD RESOURCES LIMITED, 12 CHARLES COURT
DARTMOUTH N.S. B2W 2K4 Tel. No. 462-3953

Dated this 7 day of DECEMBER 19 89

Edwin Macdonald

Signature of Licensee/Agent

I hereby make oath and say that the above statement is true and correct.

Edwin Macdonald

Signature of Licensee/Agent

for Carrick Gold

Sworn to
at

Dartmouth

REC'D
MINE
AND EN
DEC 7 1989

RECEIVED

Dec 7 15 57 89

Garrick Gold Resources Limited

MINES
AND ENERGY

WORK EXPENDITURES

8 December 1989

COW BAY LICENCE 14744

N.T.S. 11D/11C

1989 EXPENDITURES

GEOLOGY AND PROSPECTING	\$ 1150.00
GRID	175.00
ASSAYS	25.50
OVERHEADS	100.00

TOTAL	\$ 1450.50

\$1450.50 = 72.5 Man days

Licence 14744, 5 claims - Work requirement 50 Man days

Excess- Credit 22 Man days



Department of
Mines and Energy

Reed

Report of Work Performed

I, the undersigned, holder of/agent for, Exploration License No. 14745 issued on the 23 day of
NOVEMBER 19 89, hereby report work as follows:

I have, under said License, and in conformity with the provisions of The Mineral Resources Act, performed or caused to be performed on the licensed area 17.75 days' work (eight-hour days) not reported before, totalling \$ 355.00 as per the attached list of expenditures. (Rate is one day's work for each \$20.00 spent.)

Expenditures relating to office overhead, transportation, lodging, freight, express, construction of roads, erection of buildings, etc., will be accepted up to a maximum of ten percent (10%) of the **required** work.

The said work consisted of Prospecting and geological mapping

Attached is a geological report with applicable maps, sample results, drill logs, etc., which is submitted as evidence and initialled by me.

My Post Office address is CARRICK Gold Resources Limited.

Tel. No. 462-3953

Dated this 7 day of December 19 89

Edwin Macdonald
Signature of Licensee/Agent

I hereby make oath and say that the above statement is true and correct.

Edwin Macdonald
Signature of Licensee/Agent
for Carrick Gold

Sworn to
at Dartmouth
in the County of Halifax

RECEIVED
MINES
AND ENERGY
DEC 7 15 57 '89

RECEIVED
Dec 7 15 57 '89
MINES
AND ENERGY

Carrick Gold Resources Limited

WORK EXPENDITURES

8 December 1989

COW BAY LICENCE 14745

N.T.S. 11D/11C

1989 EXPENDITURES

GEOLOGY AND PROSPECTING	\$ 325.00
OVERHEADS	20.00

TOTAL	\$ 355.00

\$ 355.00 = 17.75 Man days

Licence 14744, 1 claim - Work requirement 10 Man days

Excess- Credit 7 Man days

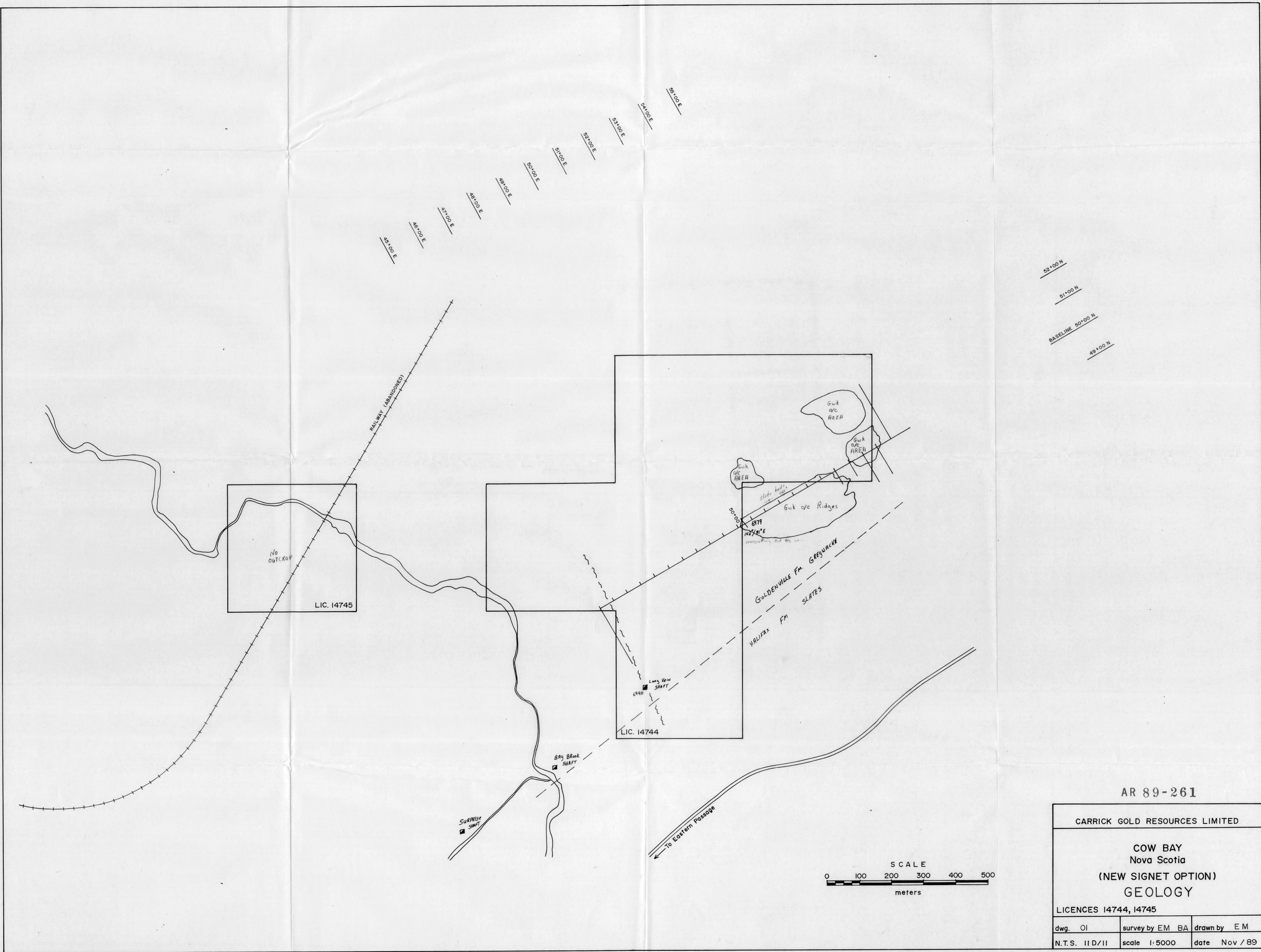

52°00' N
 51°00' N
 BASELINE 50°00' N
 49°00' N

AR 89-261

CARRICK GOLD RESOURCES LIMITED

COW BAY
 Nova Scotia
 (NEW SIGNET OPTION)
 GEOLOGY

LICENCES 14744, 14745

dwg. 01	survey by EM BA	drawn by EM
N.T.S. 11 D/11	scale 1:5000	date Nov / 89

